



Gateway Island Gallery and Studios  
Lincoln Causeway (PO Box 1473) Wodonga Vic 3689

ABN 45 663 790 551

phone: 02 6021 3073 email: admin@gigsgallery.com.au www.gigsartgallery.com.au

Open: Tuesday to Saturday, 10am to 4pm

## EXPRESSION OF INTEREST for a SOLO EXHIBITION

Thank you for your interest in having an exhibition at GIGS – Gateway Island Gallery & Studios. Our Gallery Coordinator is there to help guide you through the process of setting up and the running your exhibition.

To enable our Gallery Coordinator to tailor-make a package that suits you and your art, could you please provide the following information:

Your name:			
Contact number – Home/Work:		Mobile:	
Postal Address:			
Email Address:			
Which is your preferred gallery space:	<input type="checkbox"/> Main Gallery for 4 Weeks \$600	<input type="checkbox"/> Side Gallery for 4 Weeks \$360	<input type="checkbox"/> Side Gallery for 2 Weeks \$220
Proposed Date of Hire:	From:	To:	
Which best describes you?	<input type="checkbox"/> Current Financial Member	<input type="checkbox"/> Non-Member	
Type of Artwork you create (eg painting, sculpture, photography, etc.):			
Theme of Exhibition:			
I understand that at least 75% of the artwork is required to be saleable	Yes / No	I understand the selling price is to include the 30% commission paid to GIGS	Yes / No
Outline of Exhibition: (In 100 words or less)			

Along with this three page application form please supply 5-10 JPEG photos that reflect your artwork as well as a photo of yourself.

Please feel welcome to contact the GIGS Gallery Coordinator if you have any queries, need clarification on any matters, or require further help with organising and running your exhibition.

Gallery Coordinator: Kim Nelson-Thomson  
Email: [coordinator@gigsgallery.com.au](mailto:coordinator@gigsgallery.com.au)

---

## SITE PLAN OF GALLERIES

### Main Gallery:

The Main Gallery is defined by the purple area, see diagram below.

- Dimensions (in CM): 800L x 700W x 310H approximately
- Lights: Adjustable lights running the length of the room and in the centre, focusing on all walls
- Floor: Carpet Tiles
- Suitable for large exhibitions

### Side Gallery

The Side Gallery is defined by the yellow area, see diagram below:

- Dimensions (in CM): 600L x 300W x 230H approximately
- Lights: Fluorescent running the length of the room
- Suitable for smaller exhibitions

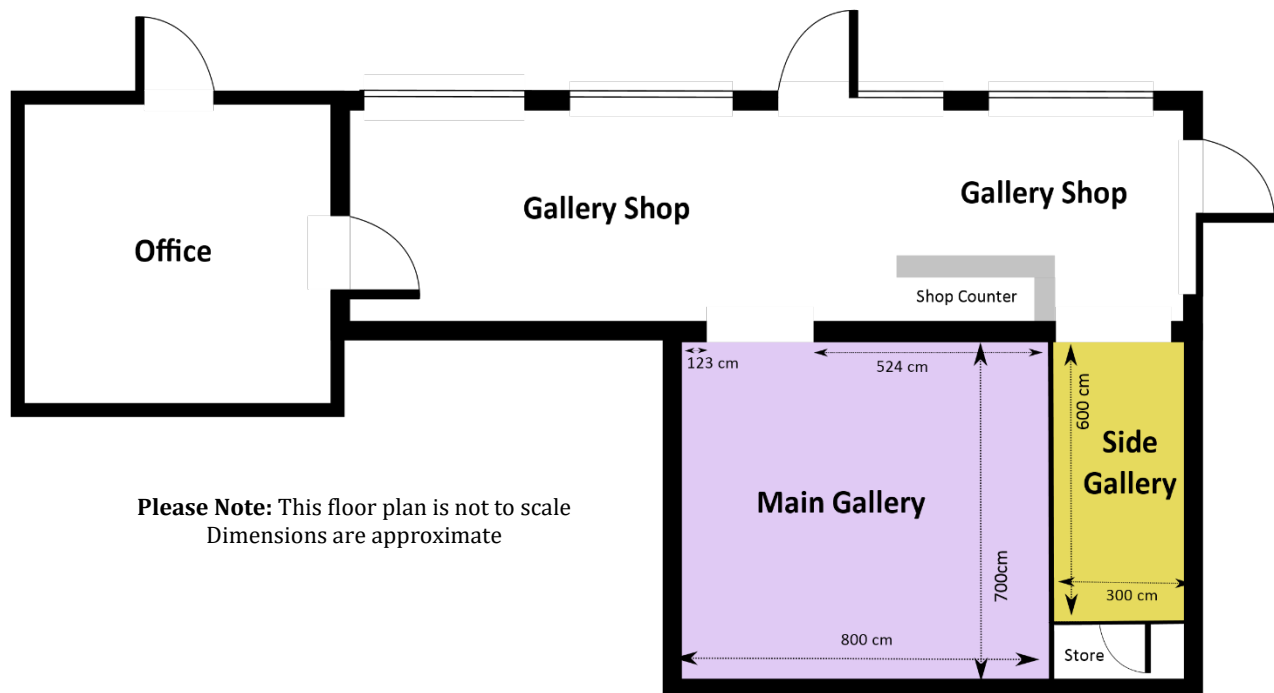

- Floor: Tiled

Please fill in the following (this information will be put onto the GIGS website):

Name:		Email:
How long have you lived in the Albury/Wodonga area?		
Describe the mediums/materials you explore/work in/study?		
Discuss how you have you educated yourself in your favoured fields?		
Talk about how long have you been pursuing your interests in visual arts/crafts?		
What do you do when you are not working on your art?		
Describe what was/is your day-job/career		
Please write your "Artists statement?" The reason and passion behind your work?		
Please attach links to your website Facebook and Instagram pages		