



Gateway Island Gallery and Studios  
Lincoln Causeway (PO Box 1473) Wodonga Vic 3689

ABN 45 663 790 551

phone: 02 6021 3073 email: admin@gigsgallery.com.au www.gigsartgallery.com.au

Open: Tuesday to Saturday, 10am to 4pm

## EXPRESSION OF INTEREST for a GROUP EXHIBITION

Thank you for your interest in having an exhibition at GIGS – Gateway Island Gallery & Studios. Our Gallery Coordinator is there to help guide you through the process of setting up and the running your exhibition.

To enable our Gallery Coordinator to tailor-make a package that suits you and your art, could you please provide the following information:

Is there a collective name for this group?				
Names of each group member:				
Name of Primary Contact:				
Contact number – Home/Work:			Mobile:	
Postal Address:				
Email Address:				
Which is your preferred gallery space:	<input type="checkbox"/> Main Gallery for 4 Weeks \$600	<input type="checkbox"/> Side Gallery for 4 Weeks \$360	<input type="checkbox"/> Side Gallery for 2 Weeks \$220	
Proposed Date of Hire:	From:		To:	
Which best describes your group?	<input type="checkbox"/> A collective of Current Financial Members	<input type="checkbox"/> A collective of Non-Members	<input type="checkbox"/> Both Current Financial Member/s and Non Members	
Type of Artwork, your group creates (eg painting, sculpture, photography, etc.):				
Theme of Exhibition:				

We understand that at least 75% of the artwork is required to be saleable	Yes / No	We understand the selling prices are to include the 30% commission paid to GIGS	Yes / No
Give an Outline of the group's objectives in this Exhibition: <i>(In 100 words or less)</i>			

Along with this application form and the form on the following page please supply:

- up to 3 JPEG photos that reflect the artwork for each person (if there are four people or under in the group)
- or 1-2 JPEG photos that reflect the artwork for each person (over four people in the group)

Please feel welcome to contact the GIGS Gallery Coordinator if you have any queries, need clarification on any matters, or require further help with organising and running your exhibition.

Gallery Coordinator: Kim Nelson-Thomson  
 Email: coordinator@gigsgallery.com.au

For each Current Financial Member in the group please fill in the following (this information will be put onto the GIGS website):

*Please fill in a separate page for each GIGS member*

Name:	Email:
How long have you lived in the Albury/Wodonga area?	
Describe the mediums/materials you explore/work in/study?	
Discuss how you have you educated yourself in your favoured fields?	
Talk about how long have you been pursuing your interests in visual arts/crafts?	
What do you do when you are not working on your art?	
Describe what was/is your day-job/career	
Please write your "Artists statement?" The reason and passion behind your work?	
Please attach links to your website Facebook and Instagram pages	

# SITE PLAN OF GALLERIES

## Main Gallery:

The Main Gallery is defined by the purple area, see diagram below.

- Dimensions (in CM): 800L x 700W x 310H approximately
- Lights: Adjustable lights running the length of the room and in the centre, focusing on all walls
- Floor: Carpet Tiles
- Suitable for large exhibitions

## Side Gallery

The Side Gallery is defined by the yellow area, see diagram below:

- Dimensions (in CM): 600L x 300W x 230H approximately
- Lights: Fluorescent running the length of the room
- Suitable for smaller exhibitions

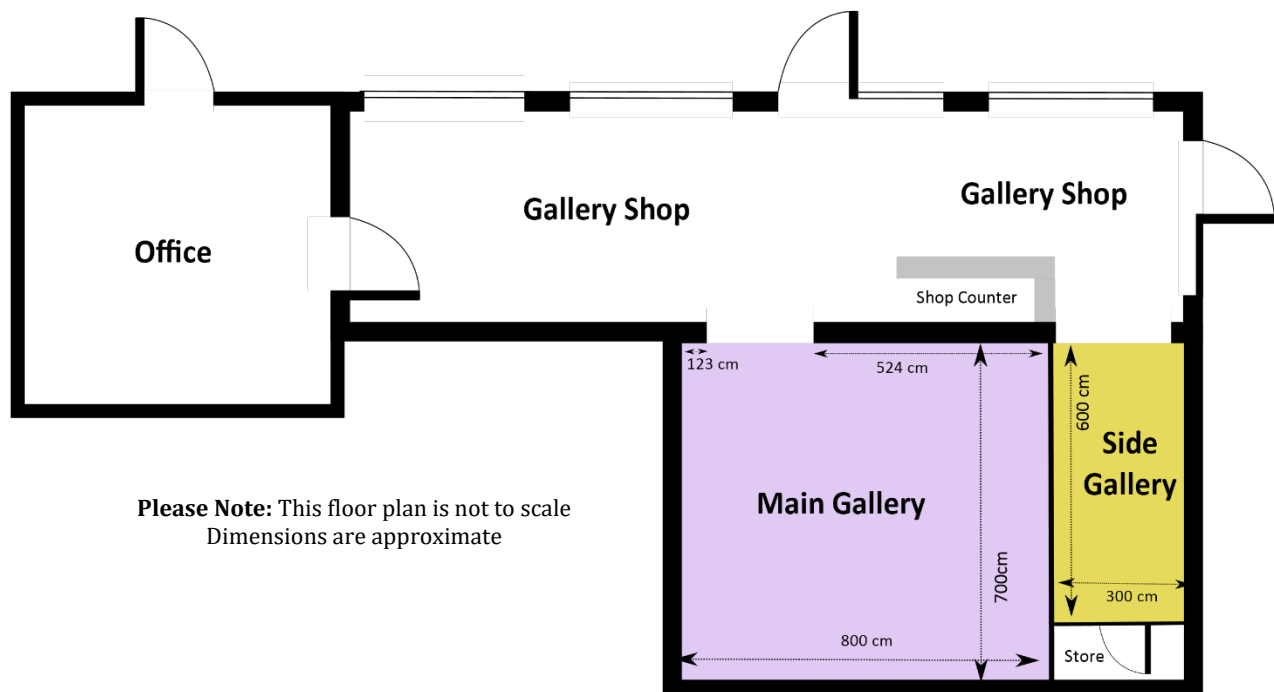

- Floor: Tiled